

# Retail for Lease

# 17+ Acres Chamberlayne Road Richmond, VA



## Traffic Counts

- Chamberlayne Rd - 15,000 AADT 2004
- Azalea Avenue - 18,000 AADT 2004

## Location

- Northeast Corner of Chamberlayne Road & Azalea Avenue
- Close proximity to Interstate 95

## Highlights

- 17+/- acres on VA Route 301/1
- Excellent visibility
- Accessible to Interstate 95
- Full ingress/egress from Chamberlayne Road & Azalea Avenue

## Demographics

	1-Mile	3-Miles	5-Miles
Population	10,657	68,424	201,510
Households	5,139	31,720	92,478
Average HH Income	\$49,147	\$47,659	\$51,286

For leasing information, contact:

Ray Schupp  
George Galloway  
(703) 836-7600  
(703) 836-7606 fax



1100 North Fayette Street • Alexandria, Virginia • 22314

[www.nextrealty.com](http://www.nextrealty.com)

All information provided is thought to be accurate and factual, however, no liability is assumed for errors and omissions.

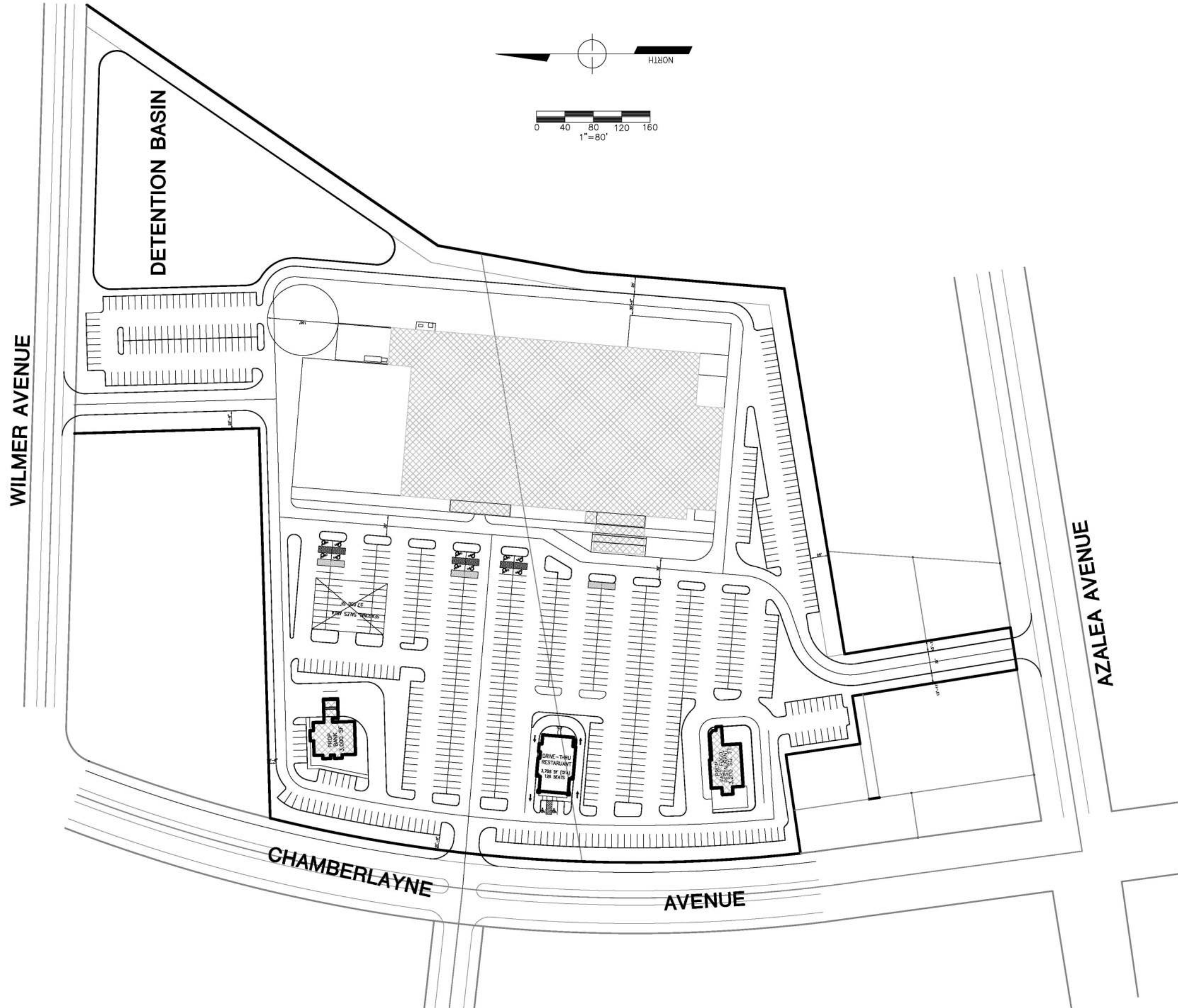



# 17+ Acres Chamberlayne Road Richmond, VA



For leasing information, contact:

Ray Schupp  
rschupp@nextrealty.com  
(703) 836-7600 ext. 17

George Galloway  
ggalloway@nextrealty.com  
(703) 836-7600 ext. 12



Next Realty Mid-Atlantic, LLC • 1100 North Fayette Street • Alexandria, VA 22314 • Main 703.836.7600 • Fax 703.836.7606  
Next Realty, LLC • Two Northfield Plaza • Suite 320 • Northfield, IL 60093 • Main 847.881.2000 • Fax 847.881.2200